

Product End-of-Life Instructions

RENOVA DIMMER

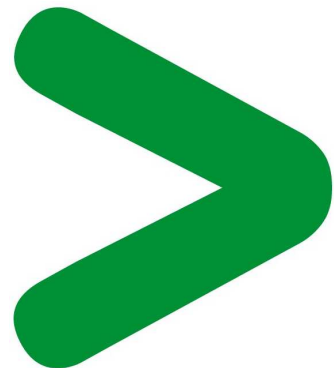

Product End-of-Life Instructions – EoLI

Product overview

The main function of the Renova Dimmer products is to offer a standard to high-end range for flush or surface mounting. Depending of version it can be combined with various kinds of design frames in different colours and materials. With the rotary dimmer insert (hereafter referred to as “dimmer”), you can use a rotary knob to switch and dim ohmic and capacitive loads such as incandescent lamps and 230 V halogen lamps and low – voltage halogen lamps with dimmable, electronic transformers. With the dimmer 20-315W/20-630W you can resistive, inductive or capacitive loads to switch and dim.

Product Range: Renova

Marketing Model/Name: Renova Dimmer Transistor 315W/VA, com. ref.: WDE011600

Size: H x L x D in mm = 71 x 71 x 52 mm

Weight in g = 115 g

Purpose

The product family must be disposed according to the legislation of the country. This document is intended for use by end of life recyclers or treatment facilities. It provides the basic information to assure an appropriate end of life treatment for the components and materials of the product.

Note:

This product family is in the scope of European Union directive 2012/19/EU on Waste Electrical and Electronic Equipment (WEEE).

Operations recommended for the end of life treatment

There are several steps to process the products at the end of life so as to recover components, materials or energy :

Reuse → Separation for special treatment → Other dismantling → Shredding

Product End-of-Life Instructions – EoLI

The components of the products that optimize the recycling performances are listed, identified and located hereunder.

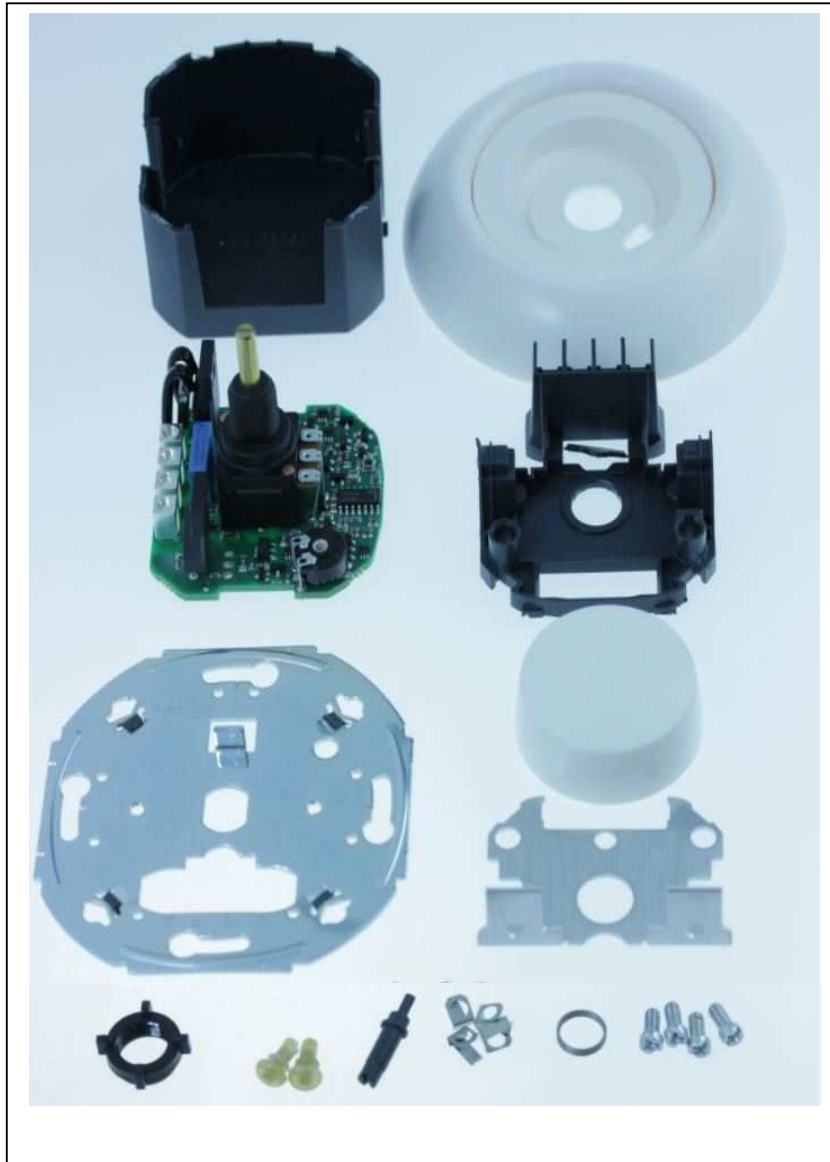

Recommendation	Number on drawing	Components	Weight (in g)	Comment
Depollution	1	PCBA (1x)	27.86g	[4]
Shredding	2	Plastic (7x)	26.16g	[1,2,3,5,6,12,13]
	3	Metal (5x)	34.44g	[7,8,9,10,11]
Dismantling	2	Plastic (1x)	0,43g	[14]

EoLI achieved with Schneider-Electric TT03 V5 procedure

Schneider Electric Industries SAS

35, rue Joseph Monier
CS 30323
F- 92506 Rueil Malmaison Cedex
RCS Nanterre 954 503 439
Capital social 896 313 776 €

www.schneider-electric.com