

**▲ WARNING / 警告**  
**RISK OF FIRE OR ELECTRIC SHOCK (FOR CONTACTOR WITH UL HI-FAULT SHORT CIRCUIT CURRENT RATINGS ONLY)**  
 The opening of the branch-circuit protective device may be an indication that a fault current has been interrupted.  
 To reduce the risk of the fire or electrical shock, current-carrying parts and other components of the controller should be examined and replaced if damaged.  
**Failure to follow these instructions can result in death, serious injury, or equipment damage.**  
 可能有火灾或者触电的危险（仅限UL高故障短路电流额定值的接触器）。  
 支路保护设备断开，表明故障电流已被中断。  
 为降低火灾或触电风险，应检查带电部件和其它控制元件，如有损坏，需及时更换。  
 不遵循上述说明可能导致人员伤亡或设备损坏。

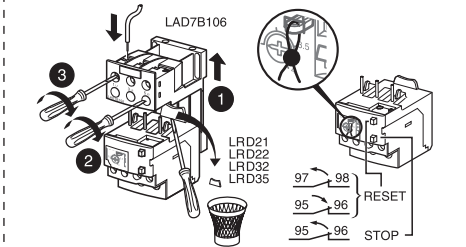

W9 1645523 0211 A07  
 04 - 2016

**Schneider Electric Industries SAS**  
 35, rue Joseph Monier  
 92506 Rueil Malmaison  
 France

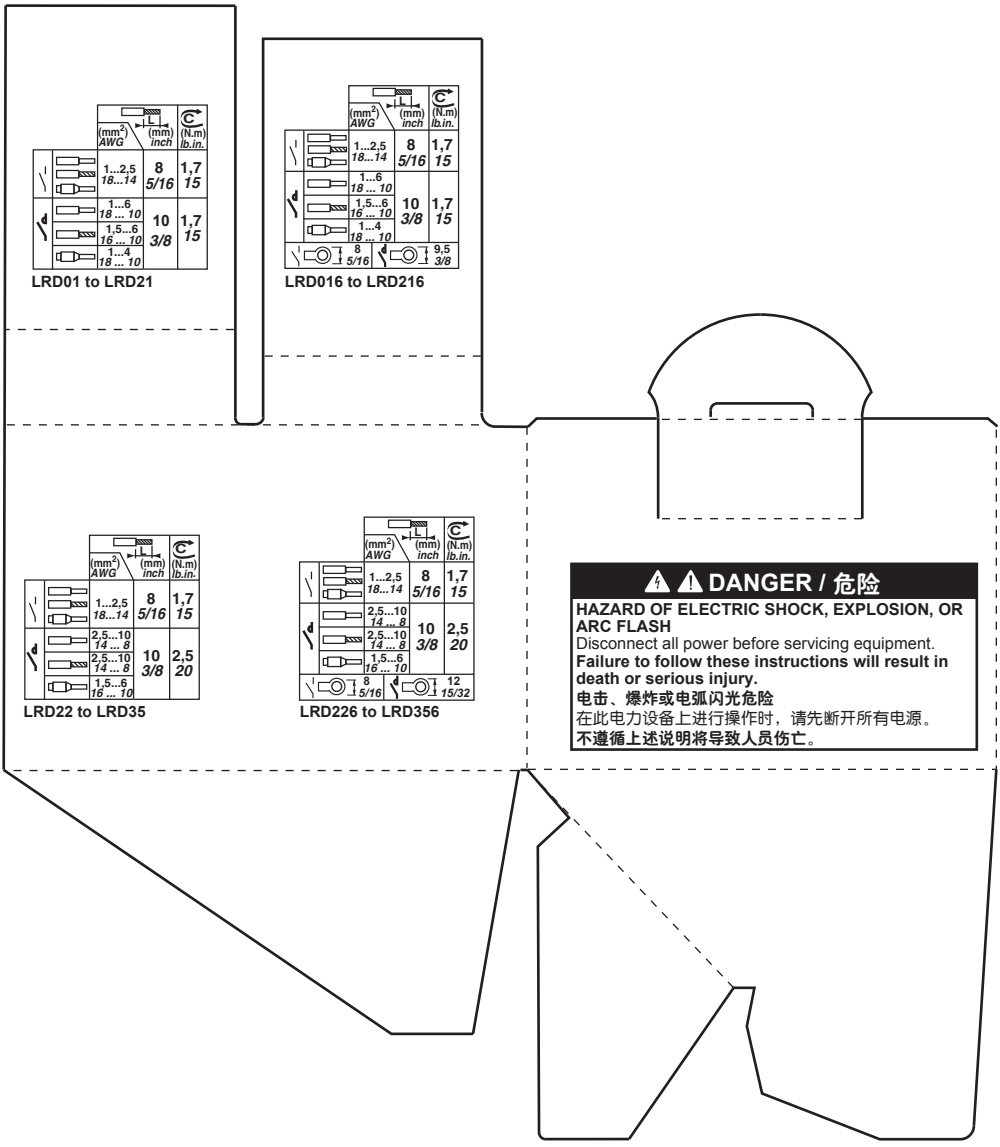

	(mm <sup>2</sup> ) AWG	(mm) inch	(N.m) lb.in.
V	1...2,5 18...14	8 5/16	1,7 15
	1...6 18...10	10 3/8	1,7 15

LRD01 to LRD21

	(mm <sup>2</sup> ) AWG	(mm) inch	(N.m) lb.in.
V	1...2,5 18...14	8 5/16	1,7 15
	1...6 18...10	10 3/8	1,7 15
d	1...6 18...10	10 3/8	1,7 15
	1...4 18...10	9,5 3/8	1,7 15

LRD016 to LRD216

	(mm <sup>2</sup> ) AWG	(mm) inch	(N.m) lb.in.
V	1...2,5 18...14	8 5/16	1,7 15
	2,5...10 14...8	10 3/8	2,5 20

LRD22 to LRD35

	(mm <sup>2</sup> ) AWG	(mm) inch	(N.m) lb.in.
V	1...2,5 18...14	8 5/16	1,7 15
	2,5...10 14...8	10 3/8	2,5 20
d	2,5...10 14...8	10 3/8	2,5 20
	1...6 18...10	8 5/16	1,7 15

LRD226 to LRD356

**⚠️ DANGER / 危险**  
**HAZARD OF ELECTRIC SHOCK, EXPLOSION, OR ARC FLASH**  
 Disconnect all power before servicing equipment.  
**Failure to follow these instructions will result in death or serious injury.**  
 电击、爆炸或电弧闪光危险  
 在此电力设备上进行操作时，请先断开所有电源。  
 不遵循上述说明将导致人员伤亡。